

JVC VU-V63KITU

STATION KIT INSTRUCTIONS

CAUTION
RISK OF ELECTRIC SHOCK
DO NOT OPEN

CAUTION: TO REDUCE THE RISK OF ELECTRIC SHOCK, DO NOT REMOVE COVER (OR BACK). NO USER-SERVICEABLE PARTS INSIDE. REFER SERVICING TO QUALIFIED SERVICE PERSONNEL.

The lightning flash with arrowhead symbol, within an equilateral triangle, is intended to alert the user to the presence of uninsulated "dangerous voltage" within the product's enclosure that may be of sufficient magnitude to constitute a risk of electric shock to persons.

The exclamation point within an equilateral triangle is intended to alert the user to the presence of important operating and maintenance (servicing) instructions in the literature accompanying the appliance.

WARNING:
TO PREVENT FIRE OR SHOCK HAZARD, DO NOT EXPOSE THIS UNIT TO RAIN OR MOISTURE.

The AC Charger Station should be used with AC 120V~, 60 Hz only in the USA and Canada. In other countries, this unit should be used with AC 110 – 240 V~, 50/60 Hz only.

CAUTION:
To prevent electric shocks and fire hazards, do NOT use any other power source.

Warning on lithium cell battery (for remote control unit)

The battery used in this device may present a fire or chemical burn hazard if mistreated. Do not recharge, disassemble, heat above 100°C (212°F) or incinerate. Replace battery with Maxell, Panasonic (Matsushita Electronic), Sanyo or Sony CR2025; use of another battery may present a risk of fire or explosion.

- Dispose of used battery properly.
- Keep away from children.
- Do not disassemble and do not dispose of in fire.

CAUTION (applies to the AC Charger Station):

TO REDUCE THE RISK OF FIRE, DO NOT REMOVE COVER (OR BACK). NO USER-SERVICEABLE PARTS INSIDE. REFER SERVICING TO QUALIFIED SERVICE PERSONNEL.

CAUTION (applies to the AC Charger Station):
TO PREVENT ELECTRIC SHOCK MATCH WIDE BLADE OF PLUG TO WIDE SLOT, FULLY INSERT.

CAUTIONS:

- If used near a radio, this unit may interfere with reception.
- Prevent inflammables, water and metallic objects from entering the unit.
- Do not disassemble or modify the unit.
- Do not apply shocks to the unit.
- Do not subject the unit to direct sunlight.
- Avoid using the unit in extremely hot or humid places.
- Avoid using the unit in places subject to vibrations.

USING HOUSEHOLD AC PLUG ADAPTER

In case of connecting the unit's power cord to an AC wall outlet other than American National Standard C73 series type use an AC plug adapter, called a "Siemens Plug", as shown.

For this AC plug adapter, consult your nearest JVC dealer.

Plug adapter (optional)

This Class B digital apparatus complies with Canadian ICES-003

Cet appareil numérique de la classe B est conforme à la norme NMB-003 du Canada.

NOTE:
The rating plate (Serial number plate) of the AC Charger Station is on the bottom of the unit.

Thank you for purchasing the JVC Station Kit.

- This product should be used with JVC Digital Video Cameras only.
- Before using, be sure to read these instructions as well as your Digital Video Camera's Instruction manual carefully.

Provided accessories

AC Charger Station
AA-V60U

DC cord

Remote control unit
RM-V712U

Lithium battery CR2025
(for remote control unit)

VIDEO/AUDIO cable
(AC Charger Station to TV or VCR, RCA plug ▶ RCA plug)

S-VIDEO cable

Editing cable
(ø3.5 mini-plug, 2 poles)

Specifications

AA-V60U AC Charger Station	
Power	U.S.A. and Canada: AC 120 V~, 60 Hz Other countries: AC 110 to 240 V~, 50/60 Hz
Power consumption	20 W
Power output	DC 7.2 V $\overline{\text{---}}$, 0.77 A (charge) DV 6.3 V $\overline{\text{---}}$, 1.8 A (VTR)
Operating temperature	0°C to 40°C (32°F to 104°F) (10°C to 35°C (50°F to 95°F) when charging)
Dimensions	80 mm (W) x 39 mm (H) x 146 mm (D) (3-3/16" x 1-9/16" x 5-3/4")
Weight	Approx. 360 g (0.8 lbs)
Charging time for BN-V607U Battery pack (based on room temperature of 10°C to 35°C)	Approx. 90 min.

RM-V712U Remote Control Unit	
Power	DC 3 V $\overline{\text{---}}$ (CR2025 Lithium battery x 1)
Operating temperature	0°C to 40°C (32°F to 104°F)
Transmission range	Approx. 5 m
Dimensions	54 mm (W) x 86 mm (H) x 12 mm (D) (2-3/16" x 3-7/16" x 1/2")
Weight	Approx. 26 g (0.06 lbs)

NOTE:
Perform charging where the temperature is between 10° and 30°C (50°F and 86°F). 20° to 25°C (68°F to 77°F) is the ideal temperature range for charging. If the environment is too cold, charging may be incomplete.

E. O. E. Design and specifications subject to change without notice.

Cautions

- Do not incinerate or disassemble; may explode or release toxic chemicals.
- Do not short circuit; may cause burns.
- When charging a brand new Battery Pack, or one that's been in storage for an extended period, the Charging Indicator may not come on. In this case, remove the Battery Pack, then reattach and try charging again.
- Vibration noise can sometimes be heard coming from the inside of the AC Power Adapter/Charger. This is normal.
- The AC Charger Station processes electricity internally, and will become warm during use. This is normal. Make sure to use the AC Charger Station in well-ventilated areas only.

Charging The Battery Pack

The battery pack has not been charged at the factory. Before using it, be sure to charge it with the AC Charger Station.

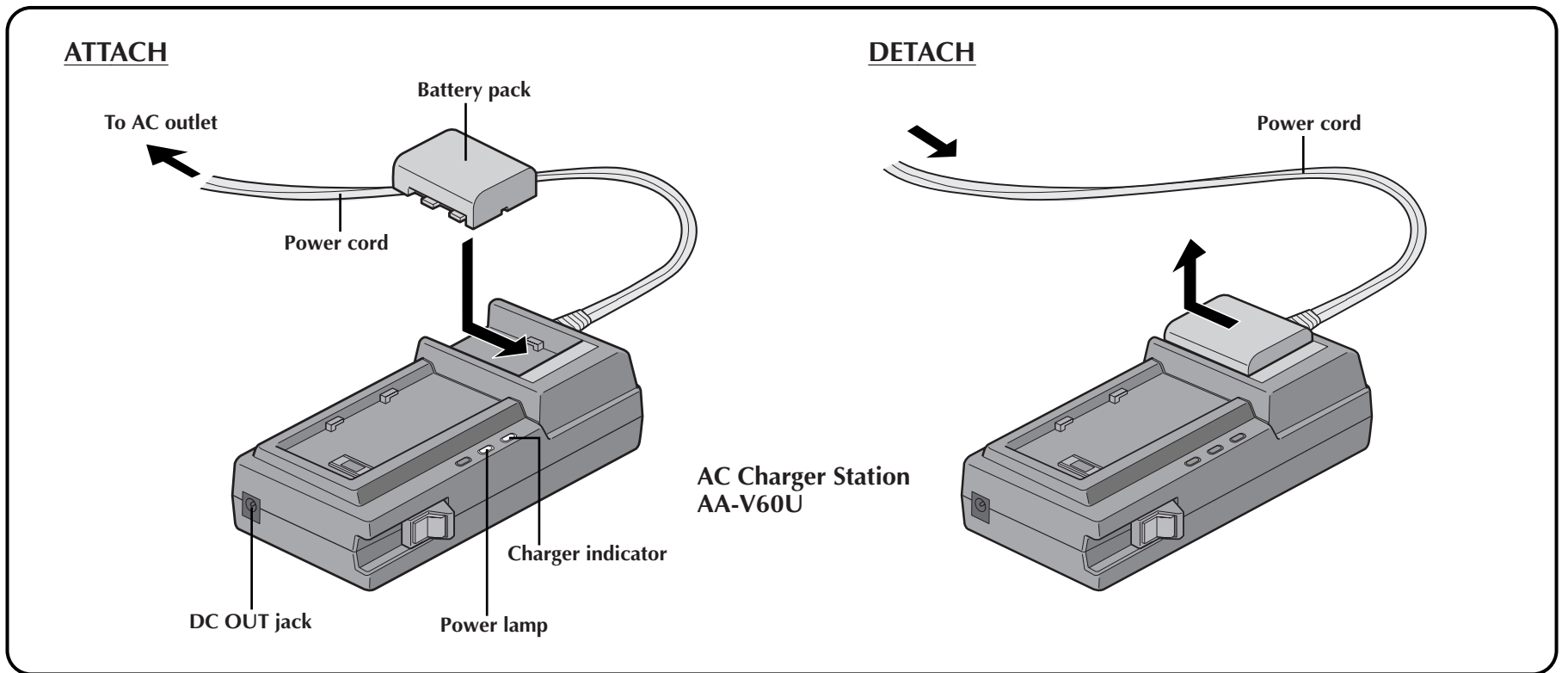

- 1** Plug the AC Charger Station's power cord into an AC outlet. The power lamp comes on.
- 2** Attach while making sure the \oplus \ominus marks are facing down and aligned with the corresponding marks on the AC Charger Station.
 - The Charger Indicator begins blinking to indicate charging has started.
- 3** When the charger indicator stops blinking but stays lit, charging is finished.
- 4** Slide the battery in the direction of the arrow and lift off.
 - Remember to unplug the AC Charger Station's power cord from the AC outlet.

NOTES:

- If you connect the camcorder's DC cord to the AC Charger Station during battery charging, power is supplied to the camcorder and charging stops.
- When using the AC Charger Station, be sure to use the supplied power cord only.
- When charging the Battery Pack for the first time or after a long storage period, the Charger Indicator may not light. In this case, remove the Battery Pack from the AC Charger Station, then try charging again.
- Since the AC Charger Station processes electricity internally, it becomes warm during use. Be sure to use it only in well-ventilated areas.
- If the battery operation time remains extremely short even after having been fully charged, the battery is worn out and needs to be replaced. Please purchase a new one.

Battery	Approximate charging time
BN-V607U (optional)	90 min.
BN-V615U (optional)	180 min.

Indoor Use

When using the camcorder indoors, you can use the AC Charger Station instead of a battery.

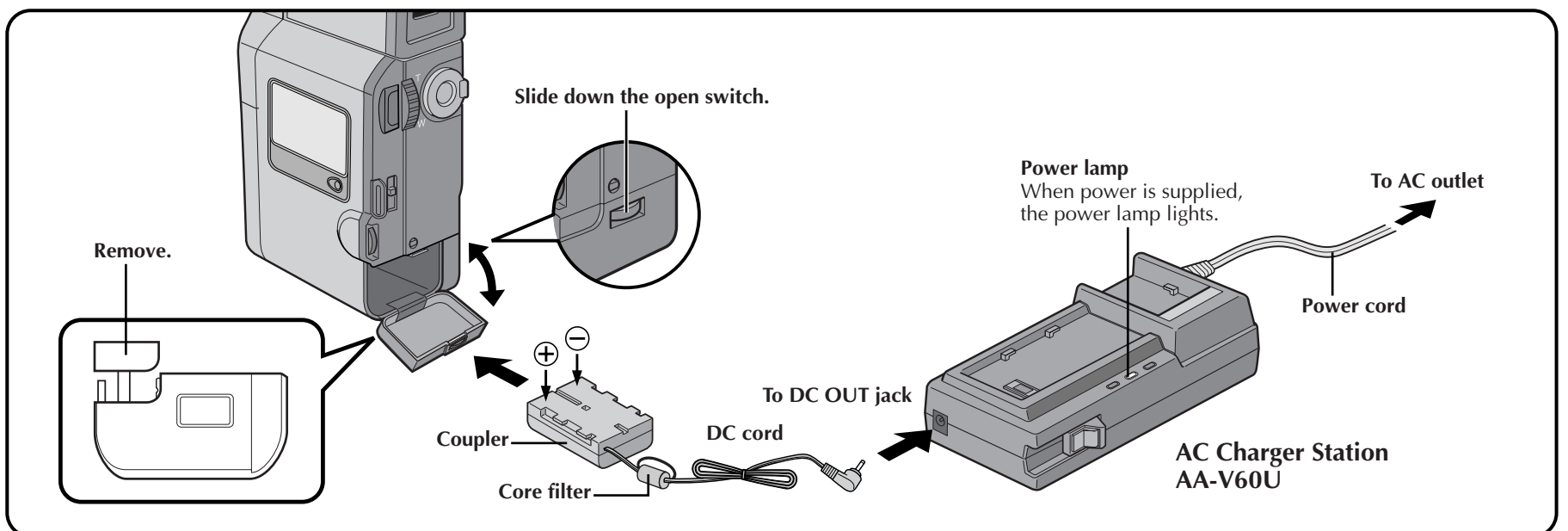

- 1** Insert the coupler of the provided DC cord into the camcorder.
- 2** Connect the DC cord to the AC Charger Station's DC OUT jack.
- 3** Plug the AC Charger Station's power cord into an AC outlet.

NOTE:

Since the AC Charger Station processes electricity internally, it becomes warm during use. Be sure to use it only in well-ventilated areas.

Refer to your Digital Video Camera's Instruction manual for more information.